



*LessCare
Cabinet*

ASSEMBLY GUIDE



KitchenCabinetKings.com
(888) 696-6454

THIS GUIDE APPLIES TO THE FOLLOWING STYLES:



Cherryville



Geneva



Newport



Richmond

ASSEMBLY INSTRUCTIONS

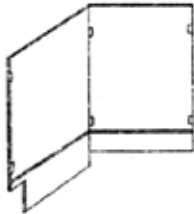

STEP 1

Aims at on the side panel on fastener and the back panel fastener inserts afterwards, and then fasten them using screwdriver to turn camlock 180 degree clockwise.

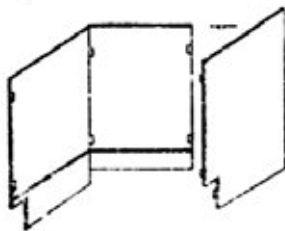

STEP 2

With first step of same, other leans together the side panel and the back panel connection.

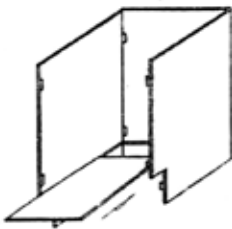

STEP 3

Insert bottom panel in the grooves at the side panels.

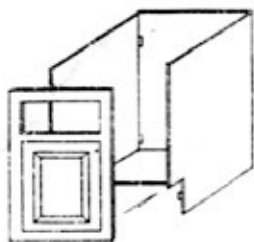

STEP 4

Aims at on the side panels after the facade in fastener the fastener inserts, and then fasten them using screwdriver to turn camlock 180 degree clockwise.

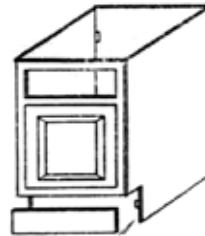

STEP 5

Facade under board and about side panels connection.

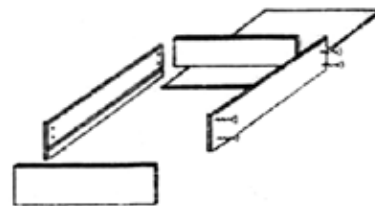

STEP 6

Assembly the drawer.

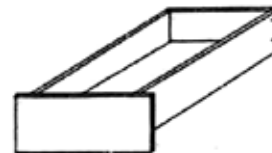

STEP 7

Finally, the drawer which assembles installs to the cabinet in.

B09 B12 B15 B18 B21 B24 B27 B30 B33 B36
B39 B42 B45 B48 SCB36 SCB42 SCB48 SB60
VB1221 VB1518 VB1521 VB1818 VB1821
VB2421 VB3021 VB1218 VB1221 VB1518
CVSB6021 CVSB3618 CVSB3621 CVSB3921
CVSB4221 CVSB4821

CHERRYVILLE & NEWPORT DOOR STYLES

1. Assemble the drawer.
2. Secure drawer glides inside the cabinet.
3. Place assembled drawer box on the glides and make sure that it locks it to place.



4. Take a piece of solid stock that is 1/4" thick and place it on the top of the door of the cabinet.
5. Using the screws from a standard drawer secure the drawer front to drawer box from inside of the cabinet.



RICHMOND DOOR STYLE

1. Assemble the drawer.
2. Secure drawer glides inside the cabinet.
3. Place assembled drawer box on the glides and make sure that it locks it to place.



4. Take a piece of solid stock that is 1" thick and place it on the top of the door of the cabinet.
5. Using the screws from a standard drawer secure the drawer front to drawer box from inside of the cabinet.



ASSEMBLY INSTRUCTIONS

DB12 DB15 DB18 DB21 DB24 LRB30 LRB36 DB12F DB15F
DB18F DB21F DB24F VDB1218 VDB1221 VDB1518 VDB1521
VDB1818 VDB1821 VDB2421

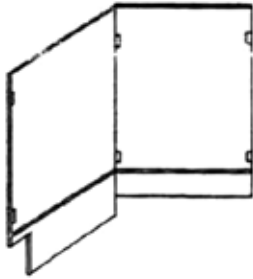

STEP 1

Aims at on the side panel on fastener and the back panel fastener inserts afterwards, and then fasten them using screwdriver to turn camlock 180 degree clockwise.

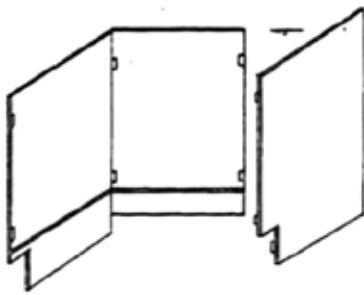

STEP 2

With first step of same, other leans together the side panel and the back panel connection.

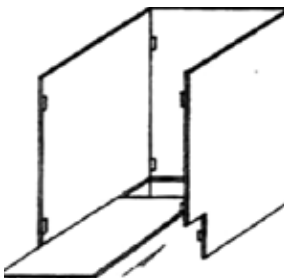

STEP 3

Insert bottom panel in the grooves at the side panels.

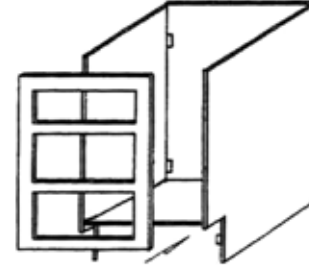

STEP 4

Aims at on the side panels after the face frame in fastener the fastener inserts, and then fasten them using screwdriver to turn camlock 180 degree clockwise.

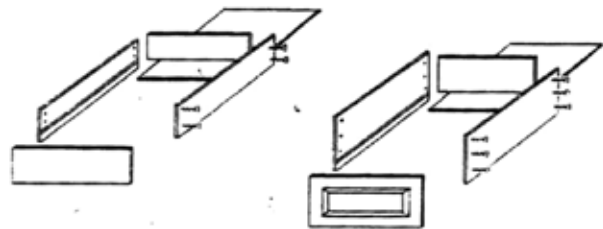

STEP 5

Assembly the drawer.

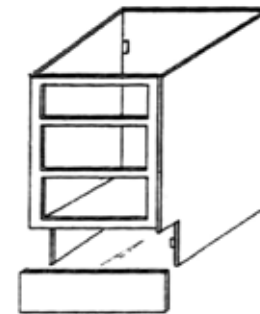

STEP 6

Facade under board and about side panels connection.

ASSEMBLY INSTRUCTIONS

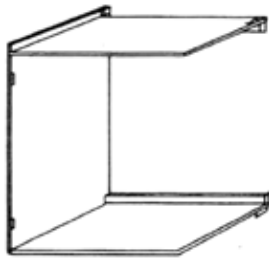

STEP 1

Aims at the side panel the top panel and the bottom panel the fastener, and then fasten them using screwdriver to turn camlock 180 degree clockwise.

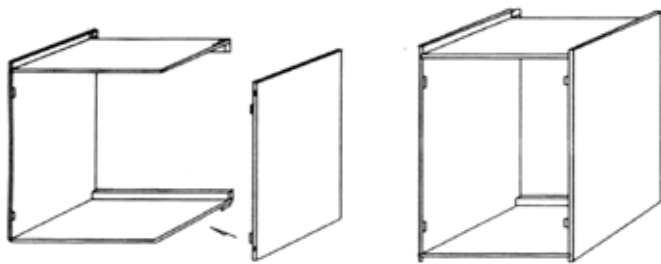

STEP 2

With first step of same, together leans the side panel to connect in addition.

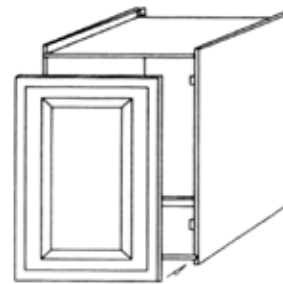

STEP 3

The door open, on the frame fastener aims at on the side panels the fastener, and then fasten them using screwdriver to turn camlock 180 degree clockwise.

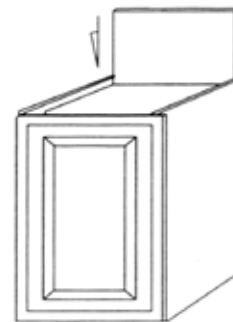

STEP 4

Insert back panel in the grooves at the rear of side panels, and fasten it with screws provided.

W3012 W3612 W3015 W3615 W3018 W3618 W3024 W3624 W0930 W1230 W1530 W1830 W2130
W2430 W2730 W3030 W3330 W3630 W3930 W4230 W4530 W4830 W0936 W1236 W1536 W1836
W2136 W2436 W2736. W3036 W3336 W3636 W3936 W4236 W0942 W1242 W1542 W1842 W2142
W2442 W2742 W3042 W3342 W3642 W3942 W4242 RW3312 RW3612 RW3315 RW3315 RW3615
RW3318 RW3618 RW3324 RW3624 SC3624 SC2430 SC3030 SC3630 SC2436 SC3036 SC3636 SC2442
SC3042 SC3642 WR3015 WR3615